



Why is this center's success important?

- Provides a state-of-the-art Field Research center close to natural resources for energy production, carbon capture, and conservation.
- Provides a center where industry and university R&D programs can work collaboratively.
- Provides researchers with an environment that is conducive to the application and commercialization of energy R&D projects.
- Provides opportunities for commercial investment in new energy applications.
- Provides job opportunities for Southwest Virginia.
- Provides a center focused on gaining energy independence.

What is in it for me?

- Potential Tax Deduction.
- Ability to work with R&D staff on research initiatives specific to your industry.
- Access to promising commercial ventures and investment opportunities that spin off from the center's research initiatives.

How Do I Help?

You can help by making a three-year financial commitment to the Southwest Virginia Higher Education Center Foundation to the *Start-Up Operating Capital Campaign for the Clean Energy Field Research Center*.

Donations to this campaign are to an IRS approved 501(c)(3) charitable organization.

Your Donation is protected - it will be managed by the Foundation, the Executive Director of the Southwest Virginia Higher Education Center and an Independent Advisory Board for the Southwest Virginia Clean Energy Field Research Center which will consist of community, industry and university representatives.

**Southwest Virginia Clean Energy
Field Research Center**
One Partnership Circle
PO Box 1987
Abingdon, VA 24210
276-619-4305

WWW.SWCENTER.EDU

SOUTHWEST VIRGINIA CLEAN ENERGY FIELD RESEARCH CENTER

START-UP OPERATING CAPITAL CAMPAIGN





WHAT IS
The Southwest Virginia
Clean Energy Field
Research Center?

A new 16,000 square foot center to be located next to the Southwest Virginia higher Education Center in Abingdon, VA. The center is being designed as a green facility and will take advantage of many state-of-the-art energy systems and construction techniques to demonstrate the use and commercialization of the technologies. In addition, the center will house research labs and faculty offices, state-of-the-art classrooms with video capabilities, a workforce training lab, conference rooms, and administrative offices.

This location allows the R&D efforts of universities and industry to be where the natural resources are extracted, used in the production of energy, and by-products and waste are created and managed. We provide a unique field research facility for researchers to see energy in its entire evolution cycle and to be able to measure and record their impact on the process.



The center is focusing on our nation's energy needs through applied commercialized research, policy and regulation assessment, and specific workforce development needs with a focus on coal and natural gas related opportunities.

Our vision is to become a regional, national, and international center for clean energy field research that unites academics and industry in the development of immediate and future clean and independent energy improvements.



Why is there a need for a Start-up Operating Capital Campaign?

Funding for the construction of the Field Research Center is provided through an \$8.0 million grant from the Virginia Tobacco Indemnification and Community Revitalization Commission.

Future operating funds will come from the Commonwealth of Virginia, industry and university R&D programs and other R&D grants.

However, there is a three year gap and this start-up operating capital campaign is necessary to fill the gap... .

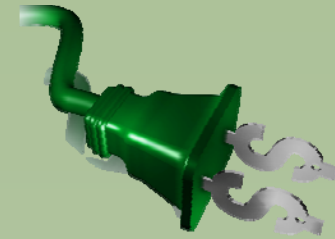

What is the Gap?

The gap is the money needed to hire highly qualified staff immediately. The staff's efforts are to begin immediately overseeing the design and construction of the center. In addition, they will develop the Center's programs, begin securing new grants for future operating funds, evaluate and secure R&D projects that will utilize the facility, and begin promoting the center and the available resources to the R&D community

SWVHEC is not doing this alone. With cooperation of leaders in the energy sector, a three year start-up budget has been developed:

Summary Budget for 2009, 2010, 2011

- Initial Operating Expenses* \$3.0 Mil
- Funding from SWVHEC \$0.6 Mil (20%)
- Funding from other sources \$0.4 Mil (15%)
- The GAP \$2.0 Mil

*Initial operating funding will be used to cover expenses such as salaries, benefits, taxes, supplies, rental space, travel and other normal and customary administrative costs.